

**PROJECT LEAD THE WAY
ONLINE CORE TRAINING
INTRODUCTION TO ENGINEERING DESIGN
AUTOMATA DESIGN CHALLENGE
BOX KIT OVERVIEW**

	ONLINE CORE TRAINING (SPRING 2018)		
	PROJECT LEAD THE WAY - INTRODUCTION TO ENGINEERING DESIGN		
	DESIGNED BY: Online Core Training	PROJECT TITLE: PLTW IED Automata Box Kit Overview	3/8
2/13/2018	SHEET # 1	FILE NAME: FL_Problem 8.2_ADC Kit.iam	cduzan

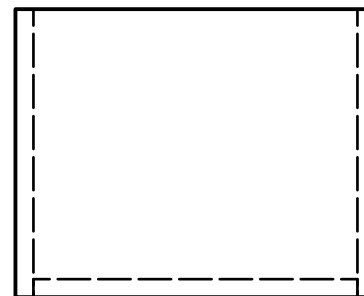
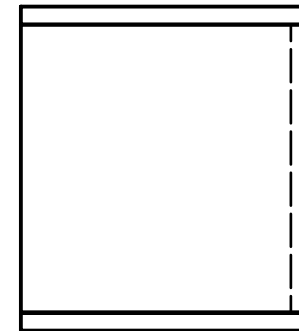
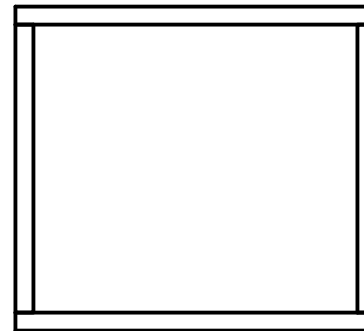
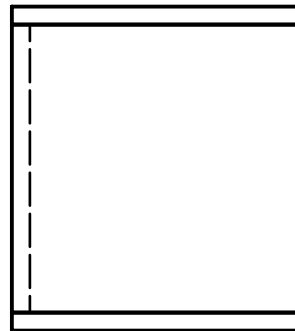
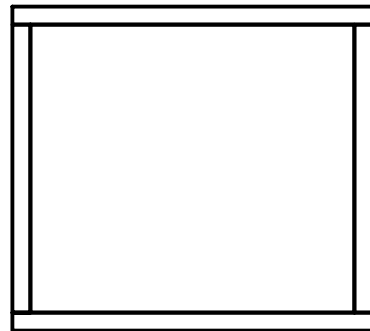
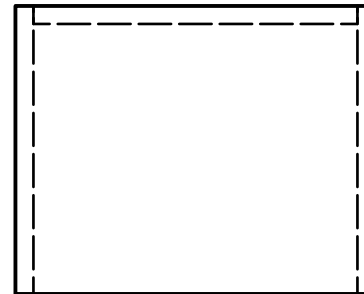
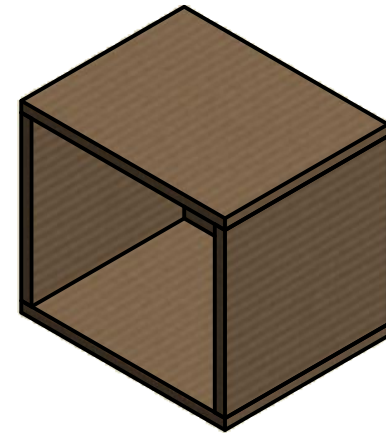

ONLINE CORE TRAINING (SPRING 2018)

PROJECT LEAD THE WAY - INTRODUCTION TO ENGINEERING DESIGN

DESIGNED BY: Online Core Training

PROJECT TITLE: PLTW IED Automata Box Kit Overview

3/8

2/13/2018

SHEET # 2

FILE NAME: FL_Problem 8.2_ADC Kit.iam

cduzan

PARTS LIST					
ITEM	QTY	FILE NAME	MATERIAL	MASS	VOLUME
1	1	FL_Problem 8.2_ADC Kit_Bottom.ipt	MDF Medium Density Fiberboard	0.145 lbmass	5.000 in ³
2	2	FL_Problem 8.2_ADC Kit_Side.ipt	MDF Medium Density Fiberboard	0.116 lbmass	4.000 in ³
3	1	FL_Problem 8.2_ADC Kit_Top.ipt	MDF Medium Density Fiberboard	0.145 lbmass	5.000 in ³
4	1	FL_Problem 8.2_ADC Kit_Back.ipt	MDF Medium Density Fiberboard	0.130 lbmass	4.500 in ³

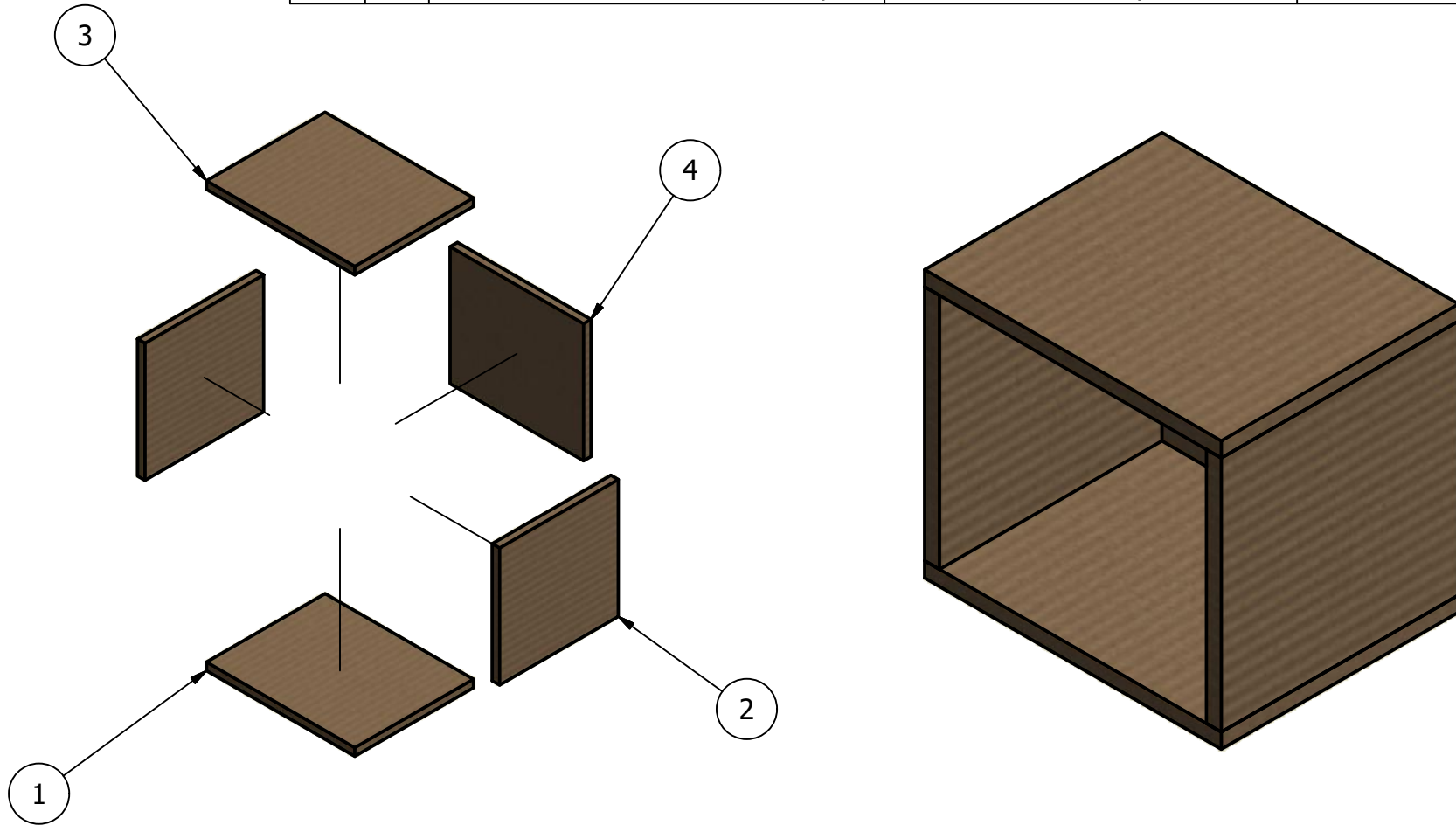

ONLINE CORE TRAINING (SPRING 2018)

PROJECT LEAD THE WAY - INTRODUCTION TO ENGINEERING DESIGN

DESIGNED BY: Online Core Training

PROJECT TITLE: PLTW IED Automata Box Kit Overview

1/4

2/13/2018

SHEET # 3

FILE NAME: FL_Problem 8.2_ADC Kit.iam

cduzan

PARTS LIST			
QTY	FILE NAME	MATERIAL	MASS
1	FL_Problem 8.2_ADC Kit_Top.ipt	MDF Medium Density Fiberboard	0.145 lbmass

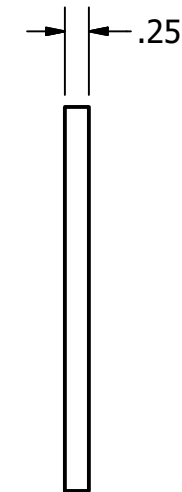
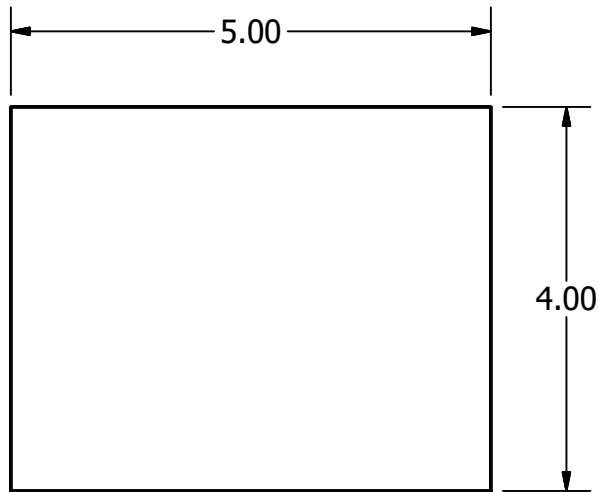
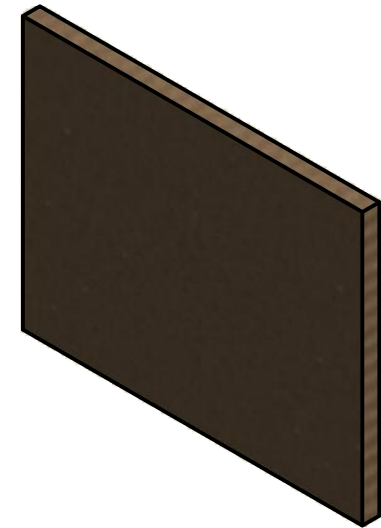

	ONLINE CORE TRAINING (SPRING 2018)		
	PROJECT LEAD THE WAY - INTRODUCTION TO ENGINEERING DESIGN		
	DESIGNED BY: Online Core Training	PROJECT TITLE: PLTW IED Automata Box Kit Overview	1/2
2/13/2018	SHEET # 4	FILE NAME: FL_Problem 8.2_ADC Kit_Top.ipt	cduzan

PARTS LIST

QTY	FILE NAME	MATERIAL	MASS
1	FL_Problem 8.2_ADC Kit_Bottom.ipt	MDF Medium Density Fiberboard	0.145 lbmass

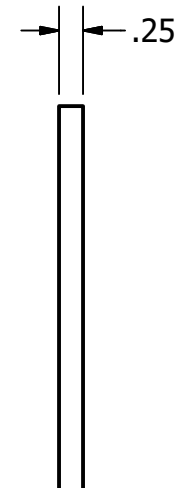
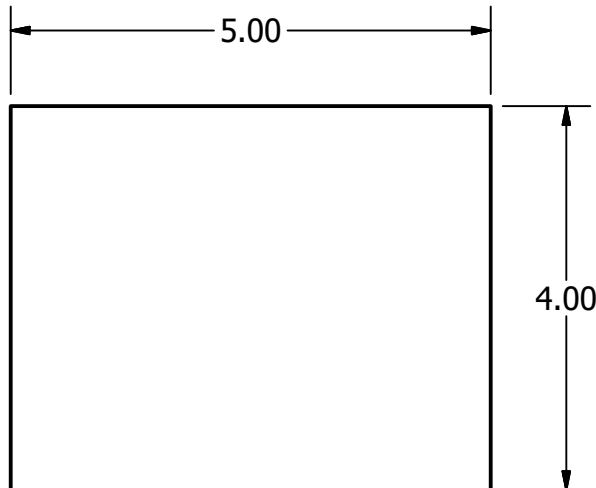
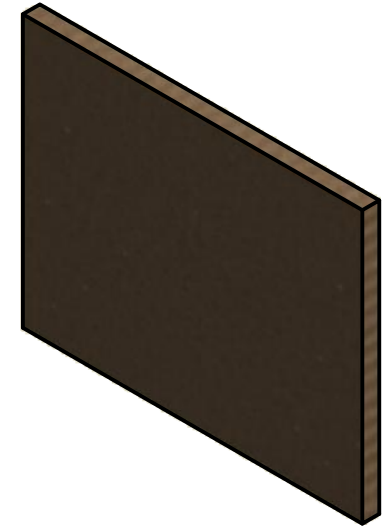

ONLINE CORE TRAINING (SPRING 2018)

PROJECT LEAD THE WAY - INTRODUCTION TO ENGINEERING DESIGN

DESIGNED BY: Online Core Training		PROJECT TITLE: PLTW IED Automata Box Kit Overview	1/2
2/13/2018	SHEET # 5	FILE NAME: FL_Problem 8.2_ADC Kit_Bottom.ipt	cduzan

PARTS LIST			
QTY	FILE NAME	MATERIAL	MASS
2	FL_Problem 8.2_ADC Kit_Side.ipt	MDF Medium Density Fiberboard	0.116 lbmass

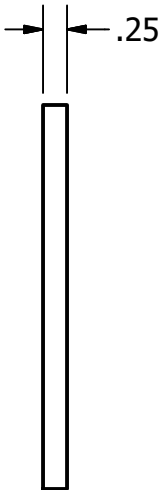
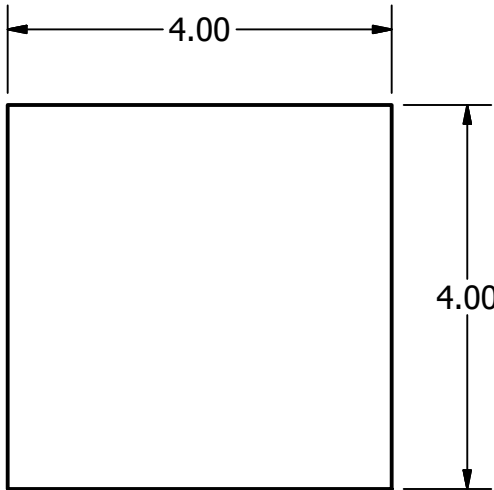
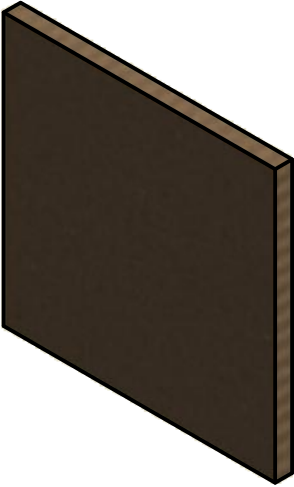

ONLINE CORE TRAINING (SPRING 2018)			
PROJECT LEAD THE WAY - INTRODUCTION TO ENGINEERING DESIGN			
<i>DESIGNED BY:</i> Online Core Training		<i>PROJECT TITLE:</i> PLTW IED Automata Box Kit Overview	
2/13/2018	<i>SHEET #</i> 6	<i>FILE NAME:</i> FL_Problem 8.2_ADC Kit_Side.ipt	1 / 2
			cduzan

PARTS LIST

QTY	FILE NAME	MATERIAL	MASS
1	FL_Problem 8.2_ADC Kit_Back.ipt	MDF Medium Density Fiberboard	0.130 lbmass

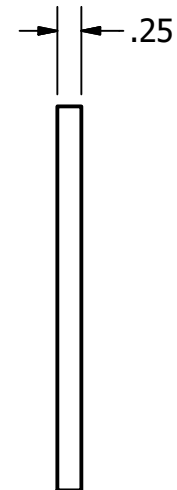
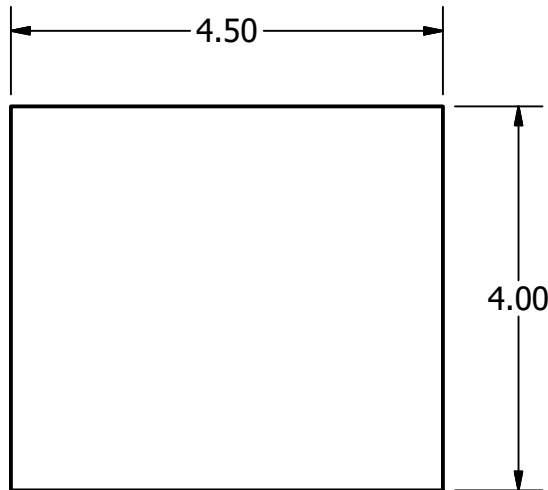
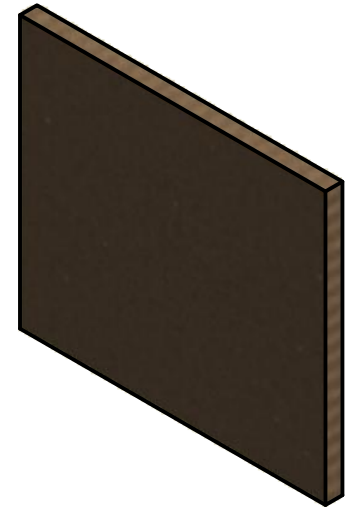

ONLINE CORE TRAINING (SPRING 2018)

PROJECT LEAD THE WAY - INTRODUCTION TO ENGINEERING DESIGN

DESIGNED BY: Online Core Training

PROJECT TITLE: PLTW IED Automata Box Kit Overview

1 / 2

2/13/2018

SHEET # 7

FILE NAME: FL_Problem 8.2_ADC Kit_Back.ipt

cduzan

PARTS LIST

QTY	FILE NAME	MATERIAL	MASS
1	FL_Problem 8.2_ADC Kit_Corrugated Plastic.ipt	Corrugated Plastic	0.155 lbmass

NOTE:
CORRUGATED SHEET
CHAMBERS ARE
APPROXIMATELY .125" X .125"



DETAIL D
 SCALE 2

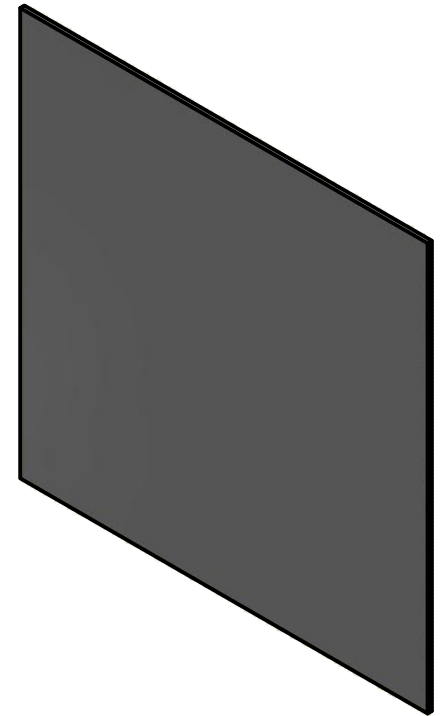
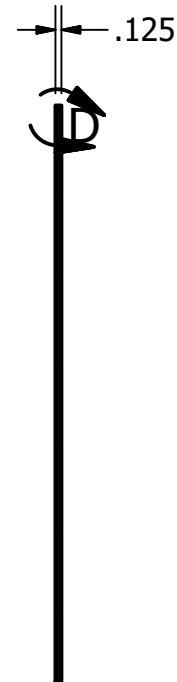
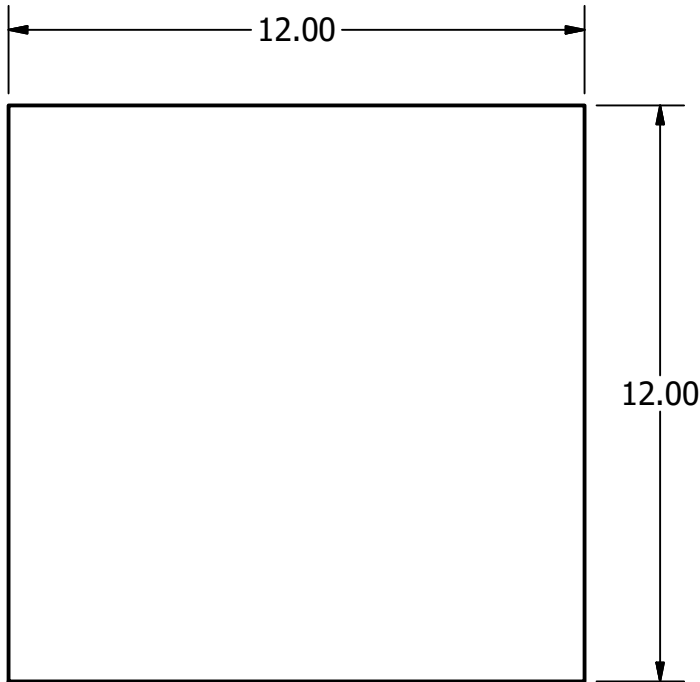

ONLINE CORE TRAINING (SPRING 2018)

PROJECT LEAD THE WAY - INTRODUCTION TO ENGINEERING DESIGN

DESIGNED BY: Online Core Training		PROJECT TITLE: PLTW IED Automata Box Kit Overview	1 / 4
2/13/2018	SHEET # 8	FILE NAME: FL_Problem 8.2_ADC Kit_Corrugated Plastic.ipt	cduzan

PARTS LIST

QTY	FILE NAME	MATERIAL	MASS
2	FL_Problem 8.2_ADC Kit_Round Dowel.ipt	Wood (Birch)	0.002 lbmass

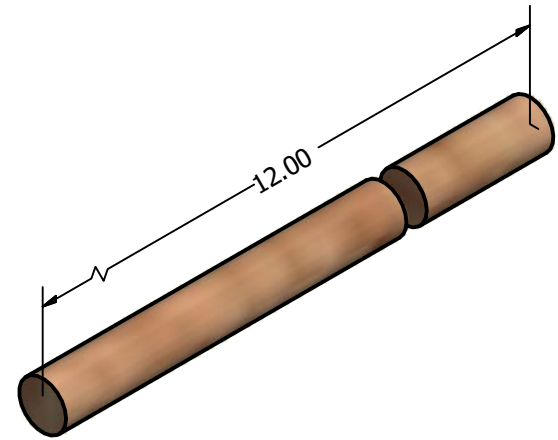

NOTE:
ISOMETRIC VIEW BROKEN TO FIT
AND SHOW SHAPE

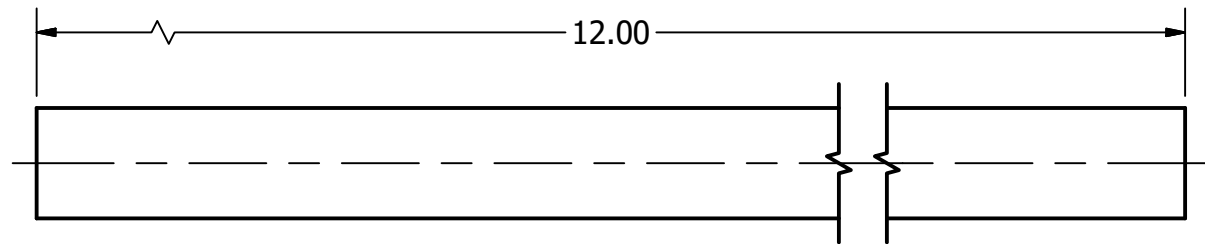
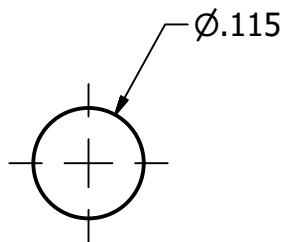

ONLINE CORE TRAINING (SPRING 2018)

PROJECT LEAD THE WAY - INTRODUCTION TO ENGINEERING DESIGN

DESIGNED BY: Online Core Training

PROJECT TITLE: PLTW IED Automata Box Kit Overview

5:1

2/13/2018

SHEET # 9

FILE NAME: FL_Problem 8.2_ADC Kit_Round Dowel.ipt

cduzan

PARTS LIST			
QTY	FILE NAME	MATERIAL	MASS
1	FL_Problem 8.2_ADC Kit_Square Dowel.ipt	Wood (Birch)	0.015 lbmass

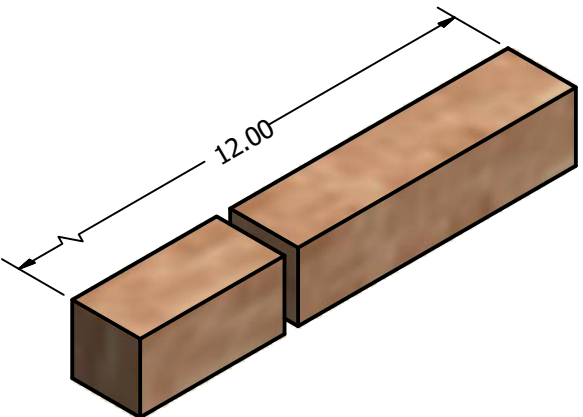

NOTE:
ISOMETRIC VIEW BROKEN TO FIT
AND SHOW SHAPE

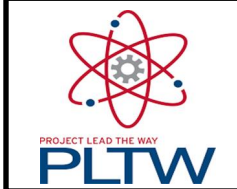
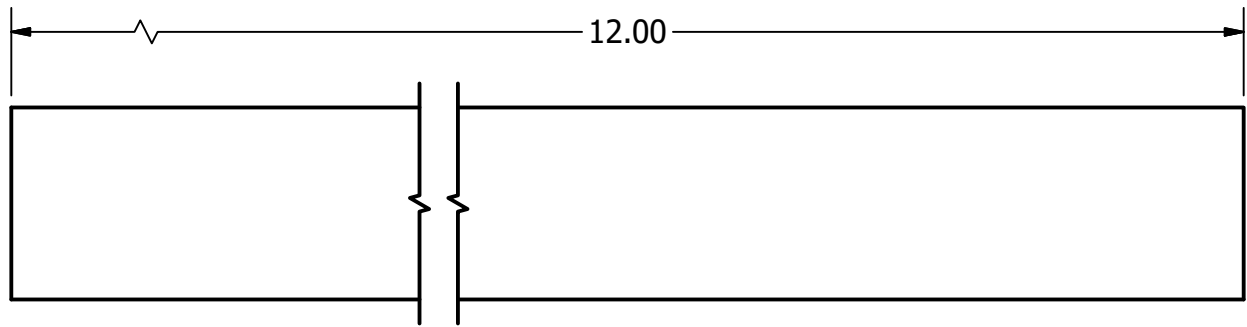
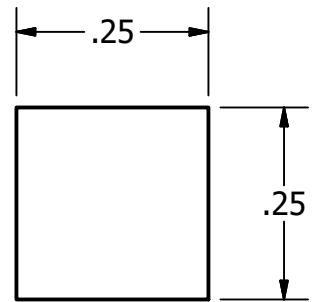

ONLINE CORE TRAINING (SPRING 2018)			
PROJECT LEAD THE WAY - INTRODUCTION TO ENGINEERING DESIGN			
DESIGNED BY: Online Core Training		PROJECT TITLE: PLTW IED Automata Box Kit Overview	
2/13/2018	SHEET # 10	FILE NAME: FL_Problem 8.2_ADC Kit_Square Dowel.ipt	4:1
			cduzan